

# MIZORAM PUBLIC SERVICE COMMISSION

## TECHNICAL COMPETITIVE EXAMINATIONS FOR RECRUITMENT TO THE POST OF ASSISTANT CONTROLLER OF MINES UNDER COMMERCE & INDUSTRIES DEPARTMENT GOVERNMENT OF MIZORAM, OCTOBER, 2022

### PAPER - I

Time Allowed : 3 hours

Full Marks : 200

*All questions carry equal marks of 2 each.*

*Attempt all questions.*

1. Recently, which of the following organizations was responsible for awarding the Mizoram Police with a prestigious 'Gold Edition 2022 Certificates' for seizure of the largest consignment of smuggled exotic animals in May and carrying out a mega disposal of narcotic substances?  
(a) Inter-pol Book of Records (b) Limca Book of Records  
(c) World Book of Records (d) Guinness World Records
2. Which state has become the first state to implement the National e-Vidhan Application (NeVa) in the State Legislative Assembly?  
(a) Mizoram (b) Nagaland  
(c) Goa (d) Kerala
3. On 24<sup>th</sup> August 2022, Mizoram government sent a consignment of homegrown pineapples from Sialhawk village to which of the following countries?  
(a) Dubai and UAE (b) Dubai and Qatar  
(c) Dubai and Egypt (d) Dubai and Bahrain
4. Subrahmanyam Jaishankar is the present minister of  
(a) Railway (b) Agriculture  
(c) External Affairs (d) Education
5. The present chairman of Rajya Sabha is  
(a) Om Birla (b) Jagdeep Dhankar  
(c) M Venkaiah Naidu (d) UU Lalit
6. India's 1<sup>st</sup> quarter GDP growth rate for the current financial year (FY23) is  
(a) 12.5 % (b) 13.5 %  
(c) 14.3 % (d) 15.5 %
7. According to the recently published 'State of the Forest Report 2021', which state has the largest area under forest cover in percentage terms?  
(a) Maharashtra (b) Madhya Pradesh  
(c) Mizoram (d) Arunachal Pradesh
8. As of September 2022, India's most valued conglomerate in terms of revenue, profits and market capitalization is  
(a) TATA Group (b) Reliance Industries  
(c) Adani Group (d) Mahindra Group

9. The youngest men's Tennis world number one Carloz Alcaraz is from which country?  
(a) Poland (b) Spain  
(c) Switzerland (d) Sweden
10. After reigning for 70 long years, Queen Elizabeth II died on  
(a) 5<sup>th</sup> September 2022 (b) 6<sup>th</sup> September 2022  
(c) 7<sup>th</sup> September 2022 (d) 8<sup>th</sup> September 2022
11. 'Bayraktar TB2', one of the most famous military equipment used in Russian-Ukraine conflict and in many other conflicts around the world is made by  
(a) USA (b) UK  
(c) Turkey (d) Russia
12. Recently, Vedanta-Foxconn has decided to establish India's first large scale semiconductor producing units in the state of  
(a) Uttar Pradesh (b) Madhya Pradesh  
(c) Gujarat (d) Maharastra
13. Which among the following authorities decides, how far the fundamental rights can apply to the members of the armed forces in India?  
(a) President of India (b) Parliament of India  
(c) Arms Forces themselves (d) Arms Forces Tribunal
14. Which of the following is **NOT** related with Articles 2 and 3 of the Constitution?  
(a) Admit new territories as new state of India  
(b) Split or merge existing Indian states  
(c) Alter the names and boundaries of existing Indian States  
(d) Appointment of Governor of the state
15. Sixth Schedule of the Indian Constitution provides for the administration of tribal areas in  
(a) Assam, Meghalaya, Sikkim and Tripura  
(b) Assam, Tripura, Arunachal Pradesh and Mizoram  
(c) Assam, Nagaland, Tripura and Mizoram  
(d) Assam, Meghalaya, Tripura and Mizoram
16. Which among the following fundamental rights is available to Indian Citizens but not to aliens?  
(a) Freedom of expression and speech (b) Equality before Law  
(c) Protection of life & liberty (d) None of the above
17. In which year, two additional Commissioners were appointed for the first time in Election Commission of India?  
(a) 1980 (b) 1985  
(c) 1989 (d) 1991
18. Which of the following Articles of the constution on India directs the State government to organize Village Panchayats?  
(a) Article 39 (b) Article 48  
(c) Article 40 (d) Article 47

19. India's Look East Policy was developed and enacted during the Prime Minister of
- (a) Rajiv Gandhi (b) Narsimha Rao  
(c) Atal Bihari Vajpayee (d) Manmohan Singh
20. Which of the following method is used for election of President in India?
- (a) Open Ballot System (b) Single Transferable Voting System  
(c) Direct Election (d) None of these
21. The IPC applies to which of the following?
1. Any offence committed within the territory of India as defined in Article (1) of constitution.  
2. Any offence committed within the territorial waters of India.  
3. Any offence committed on any ship or aircraft either owned by India or registered in India.
- Select the correct option from the codes given below:
- (a) Only 1 (b) Only 1 & 2  
(c) Only 2 & 3 (d) 1, 2 & 3
22. Who can dissolve the Lok Sabha prior to completion of its tenure?
- (a) President on recommendation of Council of Ministers  
(b) President on recommendation of the Speaker  
(c) Speaker  
(d) President on his own will
23. Which of the following is not a part of the Union executive?
- (a) The President (b) The Vice President  
(c) The Attorney General of India (d) Chief Justice of India
24. Which one of the following is not a positive interaction
- (a) Ammensalism (b) Commensalism  
(c) Mutualism (d) Proto-cooperation
25. The first Earth Summit for Convention on Biological Diversity was held at
- (a) Johannesburg (2002), South Africa (b) Rio de Janeiro (1992), Brazil  
(c) New York (1990), USA (d) London (1998), UK
26. The most important cause of loss of biodiversity is
- (a) Introduction of invasive alien species (b) Hunting  
(c) Habitat loss and fragmentation (d) Illegal trading
27. To qualify as a biodiversity hot-spot, a region must contain a least
- (a) 0.25% of endemic species (b) 0.5 % of endemic species  
(c) 1 % of endemic species (d) 1.25% of endemic species
28. According to Central Pollution Control Board, which particulate matter size in diameter (in micrometer) are responsible for causing the greatest harm to human health
- (a) 10 or less (b) 7.5 or less  
(c) 5 or less (d) 2.5 or less
29. As per the National Forest Policy (1988), the forest cover to be maintained is
- (a) 67% for hills & 33% for plains (b) 37% for hills & 11% for plains  
(c) 17% for hills & 23% for plains (d) None of the above

30. Biodiversity
- (a) Increases towards the equator
  - (b) Decreases towards the equator
  - (c) Is not affected by change in latitude
  - (d) None of the above
31. Montreal protocol is an international agreement which deals with the issue of
- (a) Green house gases
  - (b) Ozone depleting substances
  - (c) Biological diversity
  - (d) Hazardous chemicals
32. Acid rain is caused by increase in the atmospheric concentration of
- (a) SO<sub>2</sub> and NO<sub>2</sub>
  - (b) SO<sub>3</sub> and CO
  - (c) CO<sub>2</sub> and CO
  - (d) O<sub>3</sub> and dust
33. In India, the Air (Prevention and Control of Pollution) Act came into force in
- (a) 1980
  - (b) 1981
  - (c) 1982
  - (d) 1983
34. Increase in concentration of toxicant at successive trophic levels is called
- (a) Biomagnification
  - (b) Eutrophication
  - (c) Depletion
  - (d) Stratification
35. *Fano Dawi* ceremony was performed by?
- (a) Sadawt
  - (b) Bawlpu
  - (c) Daibawl
  - (d) Sadawi
36. Who among the following Chief was associated with 'Thlanrawn rawt' (Massacre)?
- (a) Vuttaia
  - (b) Lallula
  - (c) Lalsavunga
  - (d) Mangphawrha
37. The first Newspaper published in Mizo language was?
- (a) Mizo Chanchin
  - (b) Mizo Chanchin Laisuih
  - (c) Mizo leh Vai Chanchin
  - (d) Kristian Tlangau
38. Which one of the following is an essential ceremony for a person to perform 'Thangchhuah'?
- (a) Kawngpui Siam
  - (b) Khuangchawi
  - (c) Chhawngnawh
  - (d) Daibawl
39. 'Book of the Year' award was initiated by the Mizo Academy of Letters (MAL) from the year?
- (a) 1987
  - (b) 1988
  - (c) 1989
  - (d) 1990
40. A religious ceremony performed for the villager's prosperity over animals and enemies was known as?
- (a) Khal
  - (b) Sakung
  - (c) Khua leh Chawm
  - (d) Kawngpui Siam
41. Which of the following is the name of tax paid by the villagers to the Chief?
- (a) Chawng
  - (b) Fathang
  - (c) Tlahpawl
  - (d) Ngawn Chawm
42. When a person took refuge in the Chief's house owing to poverty, they are called?
- (a) Chemsen Bawi
  - (b) Tukluh Bawi
  - (c) Chung Bawi
  - (d) Inpuichhung Bawi

43. The first Mizo woman awarded with Padma Shri in Literature was?  
(a) Lalsangzuali Sailo (b) Buangi Sailo  
(c) Khawlkungi (d) Nuchhungi
44. Who among the following chief wrote a letter to the British Queen in the year 1897?  
(a) Lianphunga (b) Khamliana  
(c) Kamliana (d) Suakliana
45. In the Mizo marriage system, it is mandatory for the bride to bring along a *Pawndum* into the bridegroom's house, this special cloth is called:  
(a) Puanrin (b) Mangpuan  
(c) Puanhlap (d) Zawlpuan

**Directions (Questions No. 46 - 49) : Read the given passage carefully and answer the following questions:**

Mountaineering is now looked upon as the king of sports. But men have lived amongst the mountains since prehistoric times and in some parts of the world, as in the Andes and Himalayas, difficult mountain journeys have inevitably been part of their everyday life. However, some of the peaks there were easily accessible from most of the cities of Europe. It is quite interesting that while modern mountaineers prefer difficult routes for the greater enjoyment of sport, the early climbers looked for the easiest ones, for the summit was the prize they all set their eyes on. Popular interest in mountaineering increased considerably after the ascent of the Alpine peak of Matterhorn in 1865 and Edward Whymper's dramatic account of the climb and fatal accident which occurred during the descent.

In the risky sport of mountaineering the element of competition between either individuals or teams is totally absent. Rather one can say that the competition is between the team and the peaks themselves. The individuals making up a party must climb together as a team, for they depend upon one another for their safety. Mountaineering can be dangerous unless reasonable precautions are taken. However, the majority of fatal accidents happen to parties which are inexperienced or not properly equipped. Since many accidents are caused due to bad weather, the safe climber is the man who knows when it is time to turn back, however tempting it may be to press on and try to reach the summit.

46. Mountaineering is different from other sports because:  
(a) It is risky and dangerous (b) it can be fatal  
(c) It is most thrilling and exciting (d) There is no competition between individuals
47. People living in the Andes and the Himalayas made mountain journeys because:  
(a) It was a kind of sport (b) they had to undertake their day-to-day life  
(c) they lived in a pre-historic time (d) of the challenge offered by the difficult journey
48. Mountaineers climb as a team because:  
(a) the height is too much for one individual  
(b) the competition is between the team and the peak  
(c) they have to rely on each other for safety  
(d) there is no competition among them

49. “.....” The summit was the prize they all set their eyes on “. In the context of the passage, this means:
- (a) reaching the top was their exclusive concern
  - (b) they kept their eyes steadily on reaching the summit
  - (c) they cared for nothing but the prize of reaching the summit
  - (d) they chose a route from which they could see the summit clearly

**Directions (Questions No. 50 - 53) : Read the following passage and answer the questions based on it:**

He saw nothing, he had no knife or sharp instrument, the grating of the window was of iron and he had too often assured himself of its solidity. His furniture consisted of a bed, a chair, a table, a pail and a jug. The bed had iron clamps, but they were screwed to the wall and it would have required a screwdriver to take them off.

Dantes had but one resource which was to break the jug and with one of the sharp fragments attack the wall. He let the jug fall on the floor and it broke in pieces. He concealed two or three of the sharpest fragments in his bed, leaving the rest on the floor.

The breaking of the jug was too natural an accident to excite suspicion and next morning the gaoler went grumblingly to fetch another, without giving himself the trouble to remove the fragments. Dantes heard joyfully the key grate in the lock as the guard departed.

50. Dantes was in
- (a) a hostel
  - (b) a dining room
  - (c) an army barracks
  - (d) a prison
51. Dantes' was planning to:
- (a) carve his name
  - (b) make his escape
  - (c) tease the guard
  - (d) call for breakfast
52. The guard left the fragments because he
- (a) didn't notice them
  - (b) wished to punish Dantes
  - (c) was too lazy to bother
  - (d) wanted Dantes to clear up
53. Dantes probably broke the jug:
- (a) in the morning
  - (b) during the night
  - (c) after breakfast
  - (d) at exactly 3 P.M.

**Directions (Questions No. 54 - 56) : Read the given passage and answer the questions that follow:**

To avoid the various foolish opinions to which mankind is prone, no superhuman brain is required. A few simple rules will keep you free, not from all errors, but from silly errors. If the matter is one that can be settled by observation, make the observation yourself. Aristotle could have avoided the mistake of thinking that women have fewer teeth than man, by the simple device of asking Mrs. Aristotle to keep her mouth open while he counted. Thinking that you know when in fact you do not is a bad mistake, to which we are all prone. I believe myself that hedgehogs eat black beetles, because I have been told that they do; but if I was writing a book on the habits of hedgehogs, I should not commit myself until I had seen one enjoying this diet. Aristotle, however, was less cautious. Ancient and medieval writers know all about unicorns and salamanders; not one of them thought it necessary to avoid dogmatic statements about them because he had never seen one of them.

54. The author portrays mankind as:
- (a) very intelligent (b) having superhuman qualities  
(c) nervous and weak (d) by and large, lazy and ignorant
55. The author is in favour of drawing conclusions on the basis of
- (a) reasoning (b) study of eminent thinkers  
(c) empirical evidence (d) discussion and consultation
56. According to the author, unicorns and salamanders
- (a) existed in the past but now have become extinct  
(b) are invisible  
(c) never really existed  
(d) have caused strange stories to be written about them

**Directions (Questions No. 57 - 60): Fill in the blanks choosing the correct words or phrases from the given options:**

57. Two convicts \_\_\_\_\_ from prison last night.
- (a) has escaped (b) escape  
(c) escaped (d) were escaped
58. Run fast! The train \_\_\_\_\_ .
- (a) was whistling (b) is whistling  
(c) has whistles (d) whistled
59. It \_\_\_\_\_ by the time you get ready to leave.
- (a) will be raining (b) rains  
(c) is raining (d) had been raining
60. My brother \_\_\_\_\_ in the garden since morning.
- (a) will dig (b) has dug  
(c) digs (d) has been digging

**Directions (Questions No. 61 - 64) : Analyze the given sentences and choose the correct option:**

61. Many were called, but few were chosen.
- (a) Simple Sentence (b) Complex Sentence  
(c) Compound Sentence
62. I wrote a letter to my father.
- (a) Simple Sentence (b) Complex Sentence  
(c) Compound Sentence
63. Night came on and rain fell heavily and we all got very wet.
- (a) Simple Sentence (b) Complex Sentence  
(c) Compound Sentence
64. I want to know when you will return.
- (a) Simple Sentence (b) Complex Sentence  
(c) Compound Sentence

**Directions (Questions No. 65 - 67): Choose the word nearest in meaning to the underlined words in the following sentences:**

65. A genius tends to deviate from the routine ways of thinking.  
(a) dispute (b) differ  
(c) disagree (d) distinguish
66. The navy gave tactical support to the marines.  
(a) sensitive (b) expedient  
(c) strategic (d) expert
67. The teacher reiterated the importance of steady and hard work for success.  
(a) emphasized (b) repeated  
(c) stressed (d) furthered
68. Another name for interpersonal communication is:  
(a) Interface (b) Public communication  
(c) Dyadic communication (d) Interpersonal intelligence
69. Interpersonal communication occurs only when  
(a) Intimate conversations take place  
(b) An individual converses with people they are attracted to  
(c) An individual interacts with another person as an unique individual  
(d) Three or more people communicate with each other at the same time
70. Feedback is a listener's  
(a) Acceptance of a message (b) Facial expression  
(c) Criticism of a message (d) Verbal or nonverbal response to a message
71. Learning to communicate with others is key to  
(a) Never being misunderstood (b) Winning the approval of everyone around you  
(c) Establishing rewarding relationships (d) Establishing positive network
72. Doing something to cheer yourself up when you felt anxious or depressed involves what characteristic of emotional intelligence?  
(a) Self awareness (b) Self regulation  
(c) Empathy (d) Social skills
73. "It's all your fault" is a phrase which denotes  
(a) Assertive communication (b) Aggressive communication  
(c) Passive communication (d) Passive-aggressive communication
74. You have been waiting in line at a concert to purchase a t-shirt of your favourite band. You heard they are running out and two couples cut in line in front of you. You politely point out the long line and ask them to move to the back. This incident shows:  
(a) Assertive communication (b) Aggressive communication  
(c) Passive communication (d) Passive-aggressive communication
75. Watching the news on television makes you anxious. Turning it off indicates:  
(a) Avoidance of the stressor (b) Alteration of the stressor  
(c) Adaptation to the stressor (d) Acceptance of the stressor



76. The initial step to be taken by a teacher while introducing a new topic of study
- (a) Assessing the students previous knowledge of the subject
  - (b) Beginning with group discussions
  - (c) Giving a broad outline of the topic to be learnt
  - (d) Showing some audio visual aids

77. Temporary blocking of words is called
- (a) Stuttering
  - (b) Articulating
  - (c) Lisping
  - (d) Stammering

78. Speech is the most effective form of
- (a) Communication
  - (b) Socialization
  - (c) Speaking
  - (d) Sociability

79. How many triangles are there in the figure?

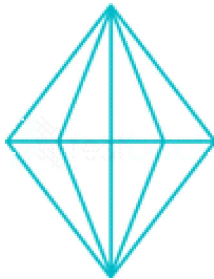

- (a) 13
  - (b) 32
  - (c) 21
  - (d) 24
80. X introduces Y saying, “He is the husband of the granddaughter of the father of my father”. How is Y related to X.
- (a) Brother
  - (b) Uncle
  - (c) Cousin
  - (d) Brother-in-law
81. Among 200 persons, 90 people like tea while 108 people like coffee and 46 people like both tea and coffee. How many persons neither like neither tea nor coffee.
- (a) 46
  - (b) 44
  - (c) 62
  - (d) 48
82. On 8<sup>th</sup> February 2020 it was Saturday. What was the day of the week on 1<sup>st</sup>, February 2016.
- (a) Sunday
  - (b) Monday
  - (c) Tuesday
  - (d) Wednesday
83. Selected the related terms for the given alternatives  
11 : GO :: 14.5 : ?
- (a) CF
  - (b) KM
  - (c) IT
  - (d) LP
84. SINGAPORE : SIMBEX :: FRANCE : ?
- (a) VARUNA
  - (b) INDRA
  - (c) KONKAN
  - (d) SLINEX

85. What is the number of triangles that can be formed whose vertices are the vertices of an octagon but have only one side common with that of octagon?
- (a) 64 (b) 32  
(c) 24 (d) 16

86. Select the missing letter from the given options?

B	J	I
E	K	B
G	U	?

- (a) O (b) M  
(c) K (d) P
87. The proportion of male students and the proportion of vegetarian students in a school are given below. The school has a total of 800 students, 80% of whom are in the secondary section and rest equally divided between class 1 and 12.

	Male (M)	Vegetarian (V)
Class 12	0.60	0.54
Class 11	0.55	0.50
Secondary section	0.275(288)	0.55(352)
Total	0.475	0.53

What is the percentage of vegetarian students in class 12.

- (a) 40 (b) 45  
(c) 50 (d) 55
88. Answer the questions on the basis of the following information.

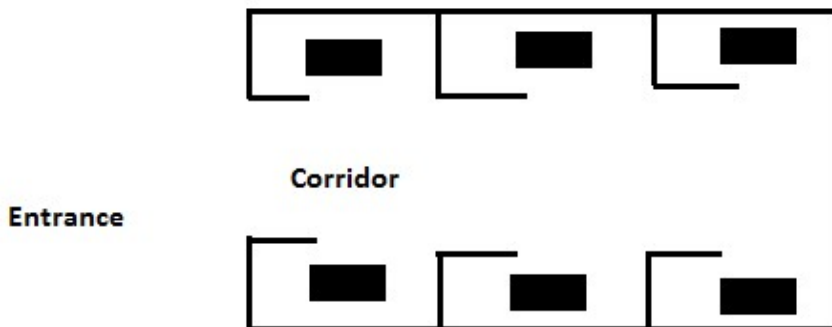

The plan above shows an office block for six officers, A, B, C, D, E and F. Both B and C occupy offices to the right of the corridor (as one enters office block) and A occupies office to the left of the corridor. E and F occupy offices on opposite sides of the corridor but their offices do not face each other. The offices of C and D face each other. E does not have a corner office. F's office is further down the corridor than A's, but on the same side. If E sits in his office and faces the corridor, whose office is to his left?

- (a) A (b) B  
(c) C (d) D

89. 12 litres of water are poured into an aquarium of dimensions 50cm length, 30cm breadth, and 40cm height. How high (in cm) will the water rise?(1 litre = 1000cm<sup>3</sup>)
- (a) 6 (b) 8  
(c) 10 (d) 20
90. You are traveling in a crowded bus and you see that an old lady is standing, and some young boys sitting on the seats reserved for the ladies. What would you suggest to them
- (a) Go and ask them to leave the seat for old lady  
(b) Request them to leave the seat for old lady.  
(c) Tell them that it is a reserved seat so they should leave it.  
(d) Ask someone else to vacate the seat for lady.
91. You are driving your car on a road suddenly a child come from the wrong side and he injured by your car. You know that, it was not your mistake. The parents of child and some other people came there.
- (a) You start shouting on them for their carelessness.  
(b) Start telling them law, that it was wrong side and the fault was of child.  
(c) Run away from the accident site.  
(d) Tell people to take the child to hospital first.

**Direction (Questions No. 92 - 93) : Your are given a list of three “nonsense or artificial” words and their English word meanings. The question(s) that follow ask you to reverse the process and translate an English word into the artificial language.**

92. *gorblflur* means fan belt  
*pixngorbl* means ceiling fan  
*arthtusl* means tile roof  
Which word could mean “ceiling tile”?
- (a) *gorbltusl* (b) *flurgorbl*  
(c) *arthflur* (d) *pixnarth*
93. *hapllesh* means cloudburst  
*srenchoch* means pinball  
*resbosrench* means ninepin  
Which word could mean “cloudnine”?
- (a) *leshsrench* (b) *ocggapl*  
(c) *haploch* (d) *haplresbo*
94. Rahul invests his savings, which is Rs.25,000 in his bank that pays 7 percent annual interest. How much will he earn by the way of interest in one year
- (a) Rs. 1500 (b) Rs. 1800  
(c) Rs. 1750 (d) Rs. 1675

95. There is a shortage of wheat in your District where you are the District Magistrate. The Government has ordered that only a maximum amount of 50 kg wheat is to be released for wedding celebrations. A daughter of your close relative is getting married and your requests you to release at least 100 kg wheat, for his daughter's wedding. He expresses annoyance when you tell him about the Government's restrictions on this matter. He feels that since you are the District Magistrate you can release any amount at your will. You do not want to spoil your relationship with him. Under such circumstances, how would you deal with the situation?
- (a) Release the extra amount of wheat which your relative has requested for.
  - (b) Refuse your relative the extra amount and strictly follow the rules.
  - (c) Show your relative the copy of the Government instructions and then persuade him to accept the amount as prescribed.
  - (d) Advise him to directly apply to the allotting authority and inform him that you do not interfere in this matter.
96. What is the decision to be taken in his case? Pandey is a player in Indian team and has no experience in coaching any of the team. But his name is included by all of the 3 cricket advisory committee members.
- (a) Referred to the cricket Advisory Committee members/BCCI secretary
  - (b) The candidate is not to be selected
  - (c) The candidate is to be selected
  - (d) Data inadequate
97. In a business, A invests  $\frac{1}{4}$  th of the total capital for  $\frac{1}{4}$  th of the time. B invests  $\frac{1}{5}$  th of the total capital for half of the time and C invests the remaining capital for the whole time. What is the share of C in the total profit of Rs 7410?
- (a) Rs 5720
  - (b) Rs 6720
  - (c) Rs 4720
  - (d) Rs 3720
98. A, B and C enter into a partnership in the ratio 2 : 3 : 5 . After 2 months, A increases his share 20% and B by 10%. If the total profit at the end of one year is Rs 1,90,500, what is the share of C at the end of year?
- (a) Rs 90,000
  - (b) Rs 70,000
  - (c) Rs 80,000
  - (d) Rs 60,000
99. A committee of 3 members is to be made out of 6 men and 5 women. What is the probability that the committee has at least two women?
- (a)  $\frac{14}{37}$
  - (b)  $\frac{14}{33}$
  - (c)  $\frac{16}{33}$
  - (d)  $\frac{14}{23}$
100. A man walks 2 km towards North. Then he turns to East and walks 10 km. After this he turns to North and walks 3 km. Again he turns towards East and walks 2 km. How far is he from the starting point?
- (a) 12 km
  - (b) 13 km
  - (c) 14 km
  - (d) 15 km